

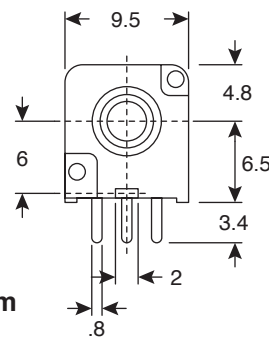

9mm Potentiometer RD901-20-15R1-XXX

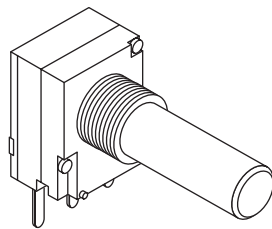

Dimensions: mm

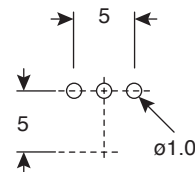
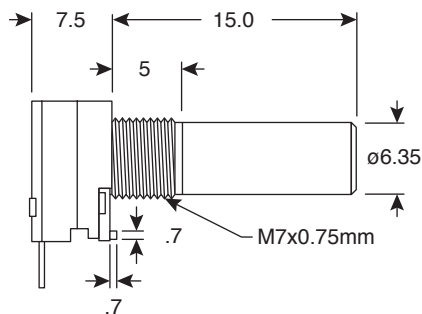

Specifications:

- Taper: Linear, PC Mount
- Rated Wattage: 0.05W
- Insulation Resistance: >100M Ω @ 250VDC
- Breakdown Voltage: 300VAC for 1 minute
- Rotation Angle: 300 $^{\circ}$ \pm 5 $^{\circ}$
- Rotation Torque: 20~250g/cm
- Tolerance: \pm 20%
- Rated Voltage: 50VAC

Tol. Unless Otherwise Stated

Less Than	10	\pm 0.3
Above	10-30	\pm 0.5
Above	30~100	\pm 1.0
Above	- - -	\pm 5 $^{\circ}$

XXX	Value	Taper
B13	1K	Linear
B53	5K	Linear
B14	10K	Linear
B54	50K	Linear
B15	100K	Linear