

A fully screened robust range of DIN connectors for use in instrumentation and audio applications. Available in two finishes; bright nickel and non-reflective electrically conductive matt black. Robust construction incorporating cable grip and strain relief. This line socket mates with all standard and lockable plugs.

Manufactured to DIN 41524, 45322, 45326, 45327 and 45329.

MATERIALS

HOUSING : Zinc Alloy, sprayed
With matt black
conductive paint

MOULDING : Nylon

CONTACTS : Brass
Silver Plated

CABLE CLAMP : Mild Steel
zinc plated

GROMMET : Black P.V.C.

ELECTRICAL RATINGS

Working Voltage 100 Vd.c. or a.c. peak

Test Voltage 1000 Vd.c.

Insulation Resist. $10^{11} \Omega$ min at 100 Vd.c.

Current Rating 4 A

Contact Resist. 10 m Ω max

Capacity (mated) 3 pF

Temp. Range -25°C to +70°C

Dimensions

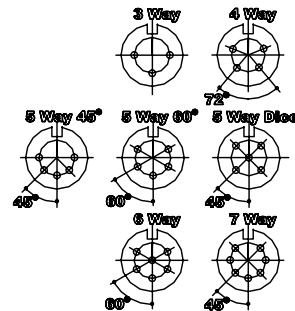
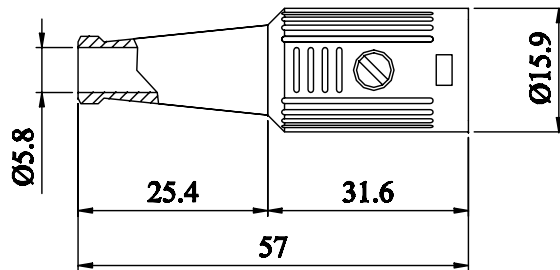

Type	Deltron No
3 Way	601-0300
4 Way	601-0400
5 Way 45°	601-0500
5 Way 60°	601-0510
5 Way Dice	601-0520
6 Way	601-0601
7 Way	601-0700

CONVERTED FROM PS0482 ISS3 (21.06.96) IN JAN 2003

DrgNo 601 SERIES

TITLE SCREENED DIN CONNECTOR LINE SOCKET (BLACK)

ALL DIMENSIONS IN MM
ANGLES IN DECIMAL DEGREES

ISSUE
3

GENERAL SPECIFICATION
FOR 601 SERIES

CUSTOMER

FILTER REF

Aprvd Date 13/10/03

Aprvd By MC

Drwn by BS

Scale: NTS

Sheet 1 / 1