

large beads - for cables up to 1.0" (25,4mm)

Sizes up to 1.0" I.D. (25,4 mm) for applications where there are large cable bundles or where great amounts of suppression are required.

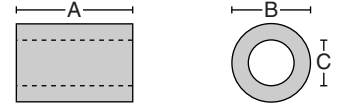

PART No.	A	B	C	IMPEDANCE IN OHMS
28B0563-0	.600 15,2	.562 14,2	.286 7,3	124 @ 100MHz
28B0625-0	.562 14,3	.625 15,9	.310 7,9	120 @ 100MHz
28B0625-1	1.125 28,6	.625 15,9	.310 7,9	225 @ 100MHz
28B0626-0	.625 15,9	.626 16,0	.133 3,4	300 @ 100MHz
28B0672-0	.672 17,1	1.000 25,4	.345 8,6	182 @ 100MHz
28B0686-2	1.125 28,6	.686 17,4	.375 9,5	196 @ 100MHz
28B0735-0	1.125 28,6	.735 18,7	.400 10,2	188 @ 100MHz
28B0736-0	1.125 28,6	.736 18,7	.430 10,9	176 @ 100MHz
28B1020-1	1.125 28,6	1.020 25,9	.505 12,8	225 @ 100MHz
28B1102-1	1.000 25,4	1.102 27,9	.620 15,7	147 @ 100MHz
28B1250-2	1.000 25,4	1.250 31,8	.750 19,1	151 @ 100MHz
28B1387-1	1.000 25,4	1.387 35,2	.882 22,4	142 @ 100MHz
28B2000-3	2.000 50,8	2.000 50,8	1.000 25,4	381 @ 100MHz

optional material formulations available upon request:

- microwave bluetooth™ 2.45 GHz peak

performance by part number:

