

# Customer Information Sheet

DRAWING No.: M52-511XX45

SHEET 3 OF 3

IF IN DOUBT - ASK

Ⓒ

NOT TO SCALE

THIRD ANGLE PROJECTION

ALL DIMENSIONS IN mm

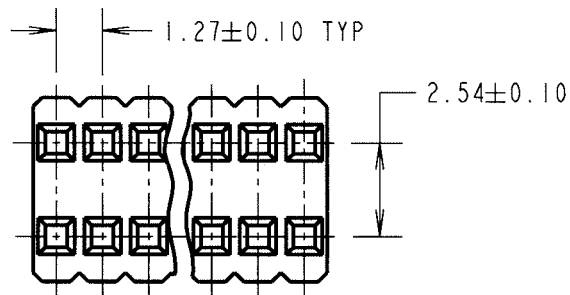

ORDER CODE:

**M52-511XX45**

No. OF WAYS PER ROW  
03 TO 50

FINISH: GOLD

**SPECIFICATIONS:**

**MATERIAL:**

MOULDING = NYLON 6T UL94V-0, BLACK

CONTACT = PHOSPHOR BRONZE

**FINISH:**

CONTACT = GOLD

**ELECTRICAL:**

CURRENT RATING = 1A

VOLTAGE PROOF = 500V AC/DC

CONTACT RESISTANCE = 20 MILLIOHMS MAX

INSULATION RESISTANCE = 5,000 MEGOHMS MIN

**ENVIRONMENTAL:**

OPERATING TEMPERATURE = -55°C TO +105°C

**PACKING:**

TUBE

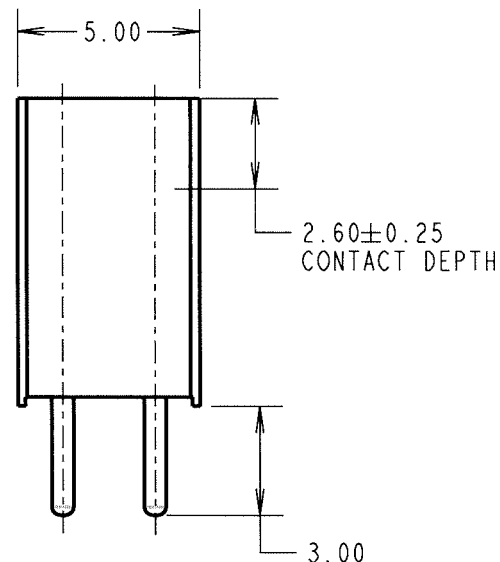
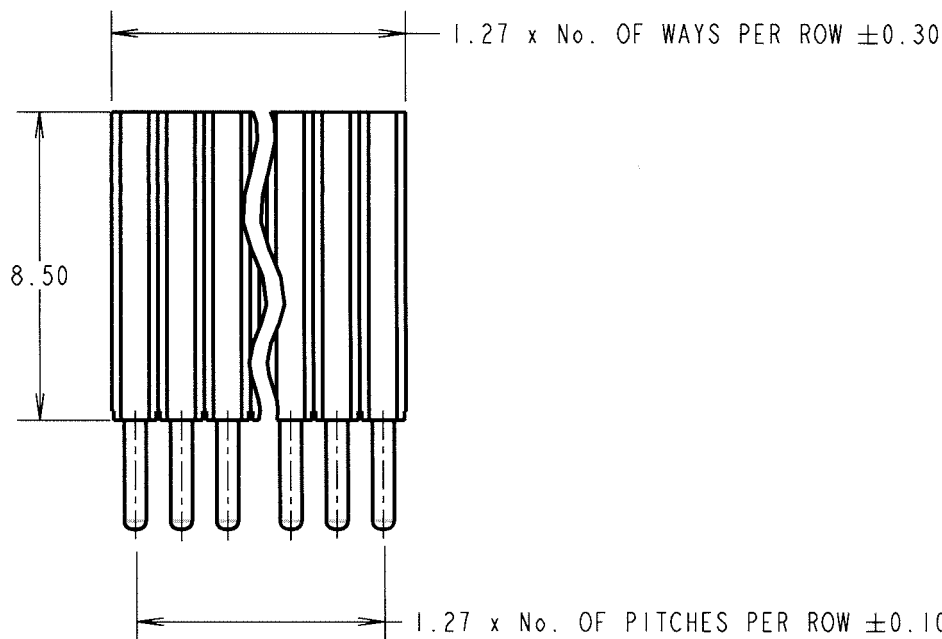

**NOTES:**

1. RECOMMENDED PCB HOLE SIZE =  $\varnothing 0.60 \pm 0.20$ mm.
2. ALL TOLERANCES ARE  $\pm 0.20$  UNLESS OTHERWISE STATED.
3. MAXIMUM MATING PIN LENGTH = 6.10mm.

JAE	4	03.05.05	8517
NAME	ISS.	DATE	C/NOTE
APPROVED: <i>[Signature]</i>			
CHECKED: <i>[Signature]</i>			
DRAWN: J. ENRIGHT			
CUSTOMER REF.:			
ASSEMBLY DRG:			

**HARWIN**

THIS DRAWING AND ANY INFORMATION OR DESCRIPTIVE MATTER SET OUT HEREON ARE CONFIDENTIAL AND COPYRIGHT PROPERTY OF THE HARWIN GROUP AND MUST NOT BE DISCLOSED, LOANED, COPIED OR USED FOR MANUFACTURING, TENDERING OR FOR ANY OTHER PURPOSE WITHOUT THEIR WRITTEN PERMISSION.

**TOLERANCES**

~~X. = ±1mm~~  
~~X.X = ±0.25mm~~  
~~X.XX = ±0.10mm~~  
~~X.XXX = ±0.01mm~~

ANGLES =  $\pm 5^\circ$

UNLESS STATED

**MATERIAL:**

SEE ABOVE

FINISH: SEE ABOVE

S/AREA:

mm<sup>2</sup>

**TITLE:**

1.27mm PITCH DIL  
VERTICAL PC TAIL SOCKET ASSY

DRAWING NUMBER:

**M52-511XX45**

SHT  
3  
OF 3

HARWIN INC  
U.S.A.

HARWIN PLC  
U.K.

HARWIN PTE  
SINGAPORE

TEL: (812) 542 2540  
FAX: (812) 542 2541

TEL: 023 9231 4545  
FAX: 023 9231 4590

TEL: 65 6779 4909  
FAX: 65 6779 3868