

# Customer Information Sheet

DRAWING No.: M80-614XXXX SHEET 2 OF 2

IF IN DOUBT - ASK

©

NOT TO SCALE

THIRD ANGLE PROJECTION

ALL DIMENSIONS IN mm

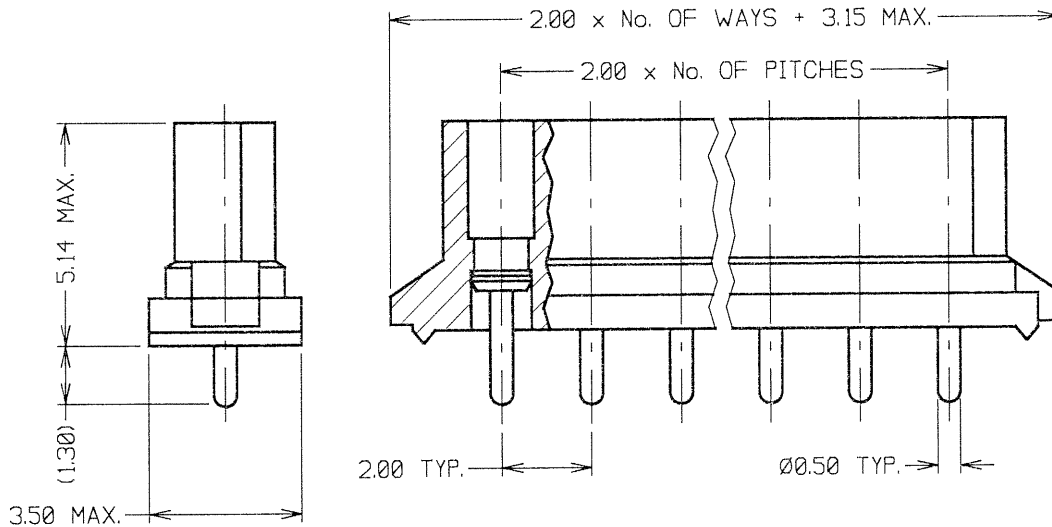

## SPECIFICATION

### MATERIALS:

MOULDING = HIGH-TEMP. POLYAMIDE 46 UL94V-0  
CLIP = BERYLLIUM COPPER  
BODY = BRASS

### FINISH:

42 = 3.5/5.0µ 100% TIN BODY, 0.3µ GOLD CLIP  
45 = 0.25/0.3µ GOLD BODY, 0.3µ GOLD CLIP

### ELECTRICAL:

CURRENT RATING AT 25°C = 3.0A MAX.  
CURRENT RATING AT 85°C = 2.2A MAX.  
WORKING VOLTAGE = 120V AC/DC  
VOLTAGE PROOF = 360V AC/DC  
CONTACT RESISTANCE:  
INITIAL = 20 MILLIOHMS MAX.  
AFTER CONDITIONING = 25 MILLIOHMS MAX.  
INSULATION RESISTANCE:  
INITIAL = 1000 MEGOHMS MIN.  
AFTER CONDITIONING = 100 MEGOHMS MIN.

### MECHANICAL:

DURABILITY = 500 OPERATIONS  
INSERTION FORCE = 2.8N MAX, 1.0N MIN.  
WITHDRAWAL FORCE = 1.8N MAX, 0.2N MIN.

### ENVIRONMENTAL:

TEMPERATURE RANGE = -55°C TO +125°C

### PACKING:

TUBE

FOR COMPLETE SPECIFICATION SEE  
COMPONENT SPECIFICATION C005XX  
(LATEST ISSUE)

## NOTES.

1. RECOMMENDED HOLE SIZE = Ø0.80mm.

ORDER CODE:

**M80-614XXXX**

No. OF WAYS \_\_\_\_\_  
02-07, 17

FINISH \_\_\_\_\_

42 = 100% TIN SHELL, GOLD CLIP  
45 = GOLD SHELL, GOLD CLIP

JMB	3	09.08.06	9373
NAME	ISS.	DATE	C/NOTE
APPROVED: <i>J.B.</i>			
CHECKED: <i>J.B.</i>			
DRAWN:		W. J. BOURNE	
CUSTOMER REF.:			
ASSEMBLY DRG.:			

# HARWIN

HARWIN USA  
TEL: 603 893 5376  
FAX: 603 893 5396  
mis@harwin.com

HARWIN Europe (UK)  
TEL: 023 9231 4545  
FAX: 023 9231 4590  
mis@harwin.co.uk

HARWIN Asia  
TEL: +65 6 779 4909  
FAX: +65 6 779 3868  
mis@harwin.com.sg

THIS DRAWING AND ANY  
INFORMATION OR DESCRIPTIVE  
MATTER SET OUT HEREON ARE  
CONFIDENTIAL AND COPYRIGHT  
PROPERTY OF THE HARWIN  
GROUP AND MUST NOT BE  
DISCLOSED, LOANED, COPIED  
OR USED FOR MANUFACTURING,  
TENDERING OR FOR ANY  
OTHER PURPOSE WITHOUT  
THEIR WRITTEN PERMISSION.

### TOLERANCES

X. = ±1mm  
X.X = ±0.25mm  
X.XX = ±0.10mm  
X.XXX = ±0.01mm  
ANGLES = ±5°  
UNLESS STATED

### MATERIAL:

SEE ABOVE

FINISH: SEE ABOVE

S/AREA:

mm<sup>2</sup>

### TITLE:

DATAMATE SIL  
FEMALE P.C TAIL ASSEMBLY

DRAWING NUMBER:

**M80-614XXXX**

SHT  
2  
OF  
2