

Fuse Strips for Diesel Vehicles Rated 36V

RoHS



Specifications

DIN 72581/2

Metal parts: Zinc-alloy

Non-housed fuse strips for Diesel vehicles.
Current rating 25A - 150A, 36 VDC. 90° fork type lugs.

Sicherungsstreifen ohne Gehäuse für Dieselfahrzeuge.
Nennstrom 25A bis 150A, 36 VDC. 90°-Anschluss in Gabelform.

Dimensions in mm / Maße in mm

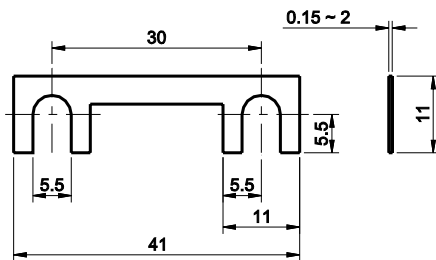

Pre-arcing Time - limits / Schmelzeit-Grenzwerte DIN

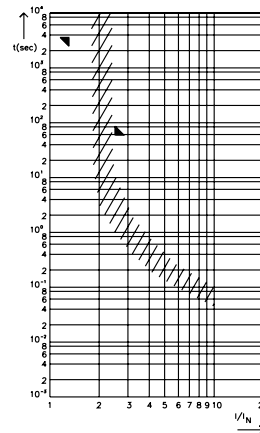

FI = 1.00 (max. operating current: $1.0 \times I_{rat}$ at 23°C)

Time-Current Characteristics / Schmelzeit-Grenzwerte

% of Rating % des Nennstromes	Opening Time Min / Max (s) Schmelzcharakteristik Min / Max (s)
130	1 h / -
250	- / 60 s

Part Number Artikel-Nr.	Current Rating Nennstrom	Typ. Voltage Drop Typ. Spannungsfall	Cold Resistance Kaltwiderstand	I ² t
156.5610.525_	25 A*	70 mV	on request	on request
156.5610.530_	30 A	70 mV	on request	on request
156.5610.540_	40 A*	70 mV	on request	on request
156.5610.550_	50 A	70 mV	on request	on request
156.5610.560_	60 A*	70 mV	on request	on request
156.5610.570_	70 A*	70 mV	on request	on request
156.5610.580_	80 A	70 mV	on request	on request
156.5610.610_	100 A	70 mV	on request	on request
156.5610.611_	120 A*	70 mV	on request	on request
156.5610.612_	125 A*	70 mV	on request	on request
156.5610.615_	150 A*	70 mV	on request	on request

*Not mentioned in the standards

Last figure of part number = packaging code, see Section "Packaging Index," pg. 157. Corresponding holder see Section "Fuse Holders."