

Midget & Electronic Fuses



<i>Midget Fuses</i>	50-54
<i>Electronic Fuses</i>	55-59
<i>Automotive Fuses</i>	60-62

Midget Fuses

Supplementary Overcurrent Protection

KLK Fuses Fast-Acting • 600 VAC



Fast-acting, high-interrupting capacity, current-limiting type fuse. Especially suited for control circuits, street lighting, H.I.D. lighting, computers, and other applications without high in-rush currents.

Voltage Rating: 600 Volts AC
500 Volts DC

Interrupting Rating: UL Listed 100,000 amperes rms symmetrical
(Capable of 200,000 amperes)

Dimensions: $\frac{13}{32}$ " x $1\frac{1}{2}$ "
Example part number (series & amperage): **KLK 1 $\frac{1}{2}$**

Ampere Ratings:

$\frac{1}{10}$	1	5	15
$\frac{1}{8}$	1 $\frac{1}{2}$	6	20
$\frac{2}{10}$	2	7	25
$\frac{1}{4}$	2 $\frac{1}{2}$	8	30
$\frac{3}{10}$	3	9	
$\frac{1}{2}$	3 $\frac{1}{2}$	10	
$\frac{3}{4}$	4	12	

RoHS

Approvals: Standard 248-14
UL Listed 3/10-30A (File No: E10480)
CSA Certified 3/10-30A (File No: LR29862)
Versions available to meet
MIL-F-5160/60, QPL F60C:
Contact Factory.

KLKD Fuses Fast-Acting • 600 VAC/DC



Fast acting, high interrupting capacity, current-limiting type fuse. Especially suited for DC control circuits, street lighting, H.I.D. lighting, computers, and other applications.

Voltage Rating: 600 Volts AC/DC

Interrupting Rating: AC: 100,000 amperes rms symmetrical;
DC: 10,000 amperes

Dimensions: $\frac{13}{32}$ " x $1\frac{1}{2}$ "
Example part number (series & amperage): **KLKD 30**

Ampere Ratings:

$\frac{1}{10}$	1	5	15
$\frac{1}{8}$	1 $\frac{1}{2}$	6	20
$\frac{2}{10}$	2	7	25
$\frac{1}{4}$	2 $\frac{1}{2}$	8	30
$\frac{3}{10}$	3	9	
$\frac{1}{2}$	3 $\frac{1}{2}$	10	
$\frac{3}{4}$	4	12	

RoHS

Approvals: Standard 248-14
UL Listed 3/10-30A (File No: E10480)
CSA Certified 3/10-30A (File No: LR29862)

FLM Fuses Time-Delay • 250 VAC



Use FLM 250 volt time-delay fuses to protect control circuit transformers, solenoids, and other circuits with high in-rush currents. Excellent for supplemental protection of small motors. For motor branch circuit protection, Refer to Class CC fuses.

Voltage Rating: 125 Volts AC
125 Volts DC self-certified @ 10KA

Interrupting Rating: AC: 10,000 amperes rms symmetrical.

Dimensions: $\frac{13}{32}$ " x $1\frac{1}{2}$ "
Example part number (series & amperage): **FLM 15**

Ampere Ratings:

$\frac{1}{10}$	1 $\frac{1}{8}$	3	8
$\frac{15}{100}$	$\frac{1}{4}$	3 $\frac{1}{2}$	9
$\frac{2}{10}$	1 $\frac{1}{10}$	3 $\frac{1}{2}$	10
$\frac{1}{4}$	1 $\frac{1}{2}$	4	12
$\frac{3}{10}$	1 $\frac{8}{10}$	4 $\frac{1}{2}$	15
$\frac{4}{10}$	1 $\frac{9}{10}$	5	20
$\frac{1}{2}$	2	5 $\frac{6}{10}$	25
$\frac{6}{10}$	2 $\frac{1}{4}$	6	30
$\frac{8}{10}$	2 $\frac{1}{2}$	6 $\frac{1}{4}$	
1	2 $\frac{9}{10}$	7	

RoHS

Approvals: Standard 248-14
UL Listed (File No: E10480)
CSA Certified (File No: LR29862)

Recommended Fuse Blocks

L60030M and LPSM series. Refer to the Blocks & Holders section of this catalog for additional information.

Midget Fuses

Supplementary Overcurrent Protection

FLQ Fuses Time-Delay • 500 VAC



These 500 volt time-delay fuses provide excellent supplemental protection of control power transformers, solenoids, and circuits with high inrush currents. UL and CSA 500 volt ratings permit use on 480 volt circuits. FLQ fuses also provide supplemental protection to small motors. For motor branch circuit protection, refer to Class CC fuses.

Voltage Rating: 500 Volts AC
300 Volts DC self-certified @ 10KA

Interrupting Rating: 10,000 amperes rms
symmetrical

Dimensions: $1\frac{3}{32}$ " x $1\frac{1}{2}$ "
Example part number (series & amperage): **FLQ 1/2**

Ampere Ratings:

$\frac{1}{10}$	$\frac{8}{10}$	$3\frac{3}{10}$	9
$\frac{1}{8}$	1	$3\frac{1}{2}$	10
$\frac{15}{100}$	$1\frac{1}{8}$	4	12
$\frac{3}{16}$	$1\frac{1}{4}$	$4\frac{1}{2}$	14
$\frac{2}{10}$	$1\frac{1}{2}$	5	15
$\frac{1}{4}$	$1\frac{9}{10}$	$5\frac{6}{10}$	20
$\frac{3}{10}$	2	6	25
$\frac{4}{10}$	$2\frac{1}{4}$	$6\frac{3}{4}$	30
$\frac{1}{2}$	$2\frac{1}{2}$	7	
$\frac{6}{10}$	3	8	

RoHS

Approvals: Standard 248-14
UL Listed (File No: E10480)
CSA Certified (File No: LR29862)

BLN Fuses Fast-Acting • 250 VAC



Fiber tube, 250 volt BLN fuses provide low-cost protection for military applications and control circuits.

Voltage Rating: 250 Volts AC

Interrupting Rating: 10,000 amperes rms
symmetrical

Dimensions: $1\frac{3}{32}$ " x $1\frac{1}{2}$ "
Example part number (series & amperage): **BLN 30**

Ampere Ratings:

1	5	12	30
2	6	15	
3	8	20	
4	10	25	

RoHS

Approvals: Standard 248-14
UL Listed (File No: E10480)
CSA Certified (File No: LR29862)
Versions available to meet MIL-F-15160/9,
QPL F09A: Contact Factory

BLF Fuses Fast-Acting • 125/250 VAC



Laminated tube BLF fuses are the lowest price midget fuse. They are suitable for control circuit and instrument protection in dry locations.

Voltage Ratings: 250 Volts AC: $\frac{1}{2}$ – 15 amperes;
125 Volts AC: 20 – 30 amperes

Interrupting Rating: 10,000 amperes rms
symmetrical

Dimensions: $1\frac{3}{32}$ " x $1\frac{1}{2}$ "
Example part number (series & amperage): **BLF 5**

Ampere Ratings:

$\frac{1}{2}$	3	7	15
1	4	8	20
$1\frac{1}{2}$	5	9	25
2	6	10	30
$2\frac{1}{2}$	$6\frac{1}{4}$	12	

RoHS

Approvals: Standard 248-14
UL Listed (File No: E10480)
CSA Certified (File No: LR29862)

Recommended Fuse Blocks

L60030M and LPSM series. Refer to the Blocks & Holders section of this catalog for additional information.

Midget Fuses

Supplementary Overcurrent Protection

RoHS

BLS Fuses Fast-Acting • 250/600 VAC



BLS fuses are 1³/₈" long in contrast to other midget fuses which are 1¹/₂". They provide space saving, low cost protection to street lighting, metering, control and electronic circuits.

Voltage Rating: 600 Volts AC: 2¹/₁₀ – 5 amperes;
250 Volts AC: 6 – 10 amperes

Interrupting Rating: 10,000 amperes rms
symmetrical

Dimensions: 1³/₃₂" x 1³/₈"
Example part number (series & amperage): **BLS 10**

Ampere Ratings:

2 ¹ / ₁₀	1 ¹ / ₂	5
4 ¹ / ₁₀	1 ⁸ / ₁₀	6
1 ¹ / ₂	1 ⁹ / ₁₀	7
3 ¹ / ₄	2	8
8 ¹ / ₁₀	3	10
1	4	

Approvals: Standard 248-14
UL Listed 2¹/₁₀-10 Amps (File No: E10480)
CSA Certified 1¹/₂ – 5 Amps
(File No: LR29862)

FLA Fuses Time-Delay • 125 VAC



FLA fuses are 125 volt, pin-indicating time-delay fuses for protection of control circuit transformers, solenoids, and other circuits with high in-rush currents. Metal indicating pin pops-out when fuse opens, giving visual indication of blown fuse. Use FLA fuses in conjunction with special fuseblocks to operate mechanical signal switches or energize alarm circuits. Fuses rated 12 amperes and above have dual-tube construction.

Voltage Rating: 125 Volts AC
Interrupting Rating: 10,000 amperes rms
symmetrical

Dimensions: 1³/₃₂" x 1¹/₂"
Example part number (series & amperage): **FLA 15**

* *Note: Dual tube construction*

Ampere Ratings:

1 ¹ / ₁₀	1 ¹ / ₈	3	8
1 ⁵ / ₁₀₀	1 ¹ / ₄	3 ² / ₁₀	10
2 ¹ / ₁₀	1 ¹ / ₁₀	3 ¹ / ₂	12*
1 ¹ / ₄	1 ¹ / ₂	4	15*
3 ¹ / ₁₀	1 ⁸ / ₁₀	4 ¹ / ₂	20*
4 ¹ / ₁₀	1 ⁹ / ₁₀	5	25*
1 ¹ / ₂	2	5 ⁶ / ₁₀	30*
6 ¹ / ₁₀	2 ¹ / ₄	6	
8 ¹ / ₁₀	2 ¹ / ₂	6 ¹ / ₄	
1	2 ⁹ / ₁₀	7	

Approvals: Standard 248-14
UL Listed (File No: E10480)
CSA Certification Pending

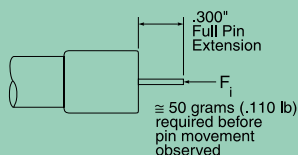

Recommended Fuse Blocks

L60030M and LPSM series. Refer to the Blocks & Holders section of this catalog for additional information.

Midget Fuses

Supplementary Overcurrent Protection

KLQ Series Fuses



The Littelfuse KLQ series is designed to protect gaseous vapor fixtures, HID ballasts, and other electronic and lighting circuits. The KLQ is the same physical size as the Littelfuse BLS, but has more time-delay to handle transient and in-rush currents.

Voltage Rating: 600 VAC
Interrupting Rating: 10,000 amperes
Approvals: Standard 248-14 UL Listed (File No: E10480)
Dimensions: $\frac{13}{32}$ " x $1\frac{3}{8}$ "

Ampere Ratings:

1	2	5
$1\frac{1}{10}$	3	6

RoHS

Recommended Fuse Blocks:

L60030M Series. Refer to the Blocks & Holders section of this catalog for additional information.

Ordering Information:

Example catalog number: KLQ005
 Example system number: OKLQ005.T

FLU Series Fuses



The Littelfuse FLU series is designed specifically for the protection of multimeters. The 1000 VAC/VDC rating also makes the FLU ideal for a variety of other applications.

Voltage Rating: 1000 VAC/VDC
Interrupting Rating: $\frac{44}{100}$ A: 10kA
 11A: 20kA
Ampere Range: FLU $\frac{44}{100}$ =1A and FLU 11 = 15A
Approvals: UL Recognized under the components program. (File No: E10480)
 CSA Certified (File No: LR29862)
Dimensions: $\frac{44}{100}$ A: $\frac{13}{32}$ " x $1\frac{3}{8}$ "
 11A: $\frac{13}{32}$ " x $1\frac{1}{2}$ "

Ordering Information

Example catalog number: FLU011
 Example system number: 0FLU011.T

RoHS

LNNB "Dummy" Fuse

Also known as a "neutral", the LNNB is actually not a fuse. It is the same physical size as a standard Midget fuse. The LNNB001 is a hollow body design for use with standard fuse clips. The LNNB002 is a solid body design for use with LEB/LEX series inline style fuse holders.

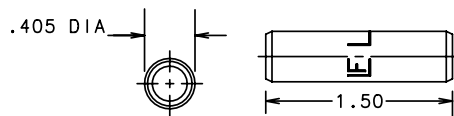

LNNB001

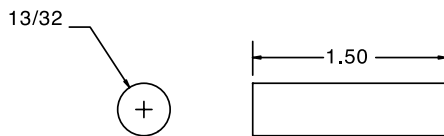

LNNB002

Specifications

Dimensions: $\frac{13}{32}$ " x $1\frac{1}{2}$ "

Ordering Information

Example catalog number: LNNB001
 Example system number: LNNB0001Z

Example catalog number: LNNB002
 Example system number: LNNB0002Z

Midget Fuses

Supplementary Overcurrent Protection

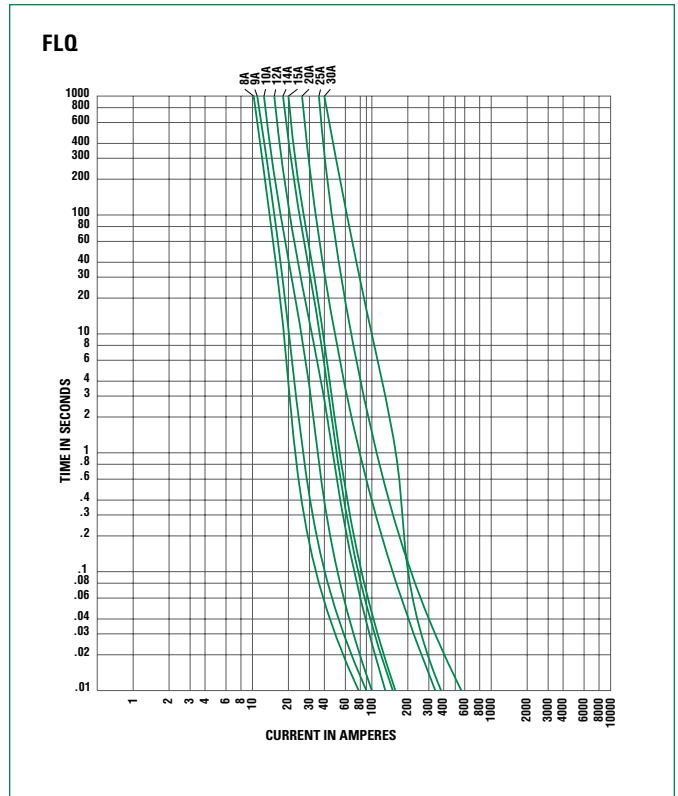
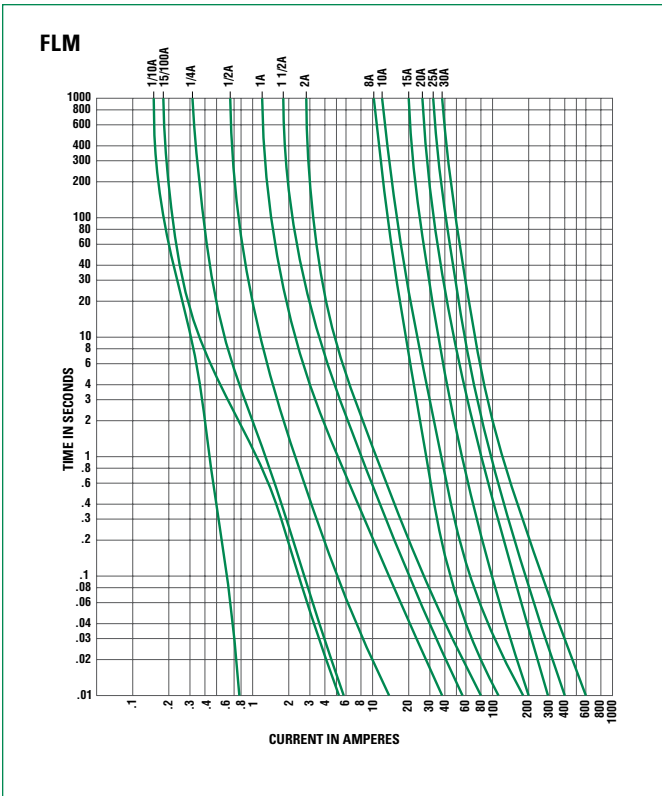
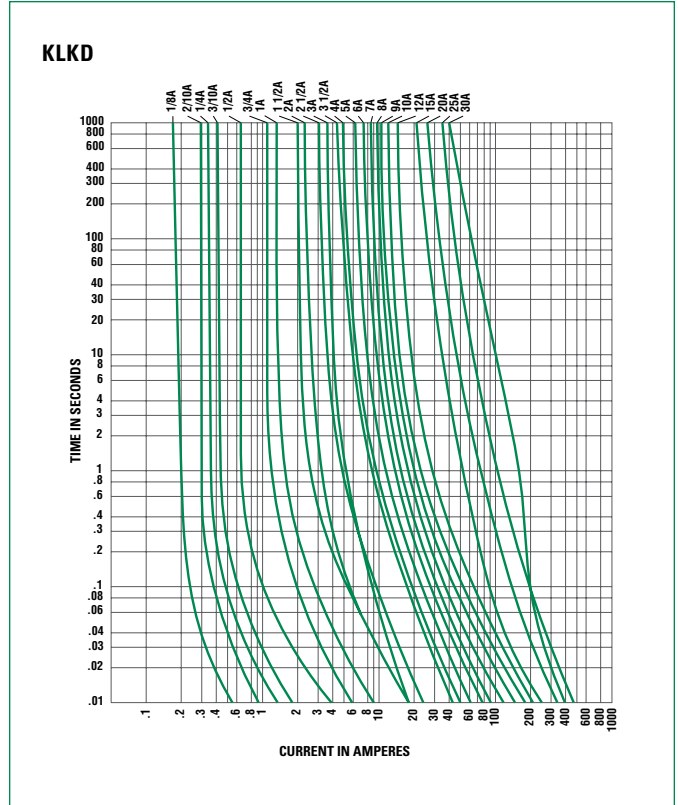
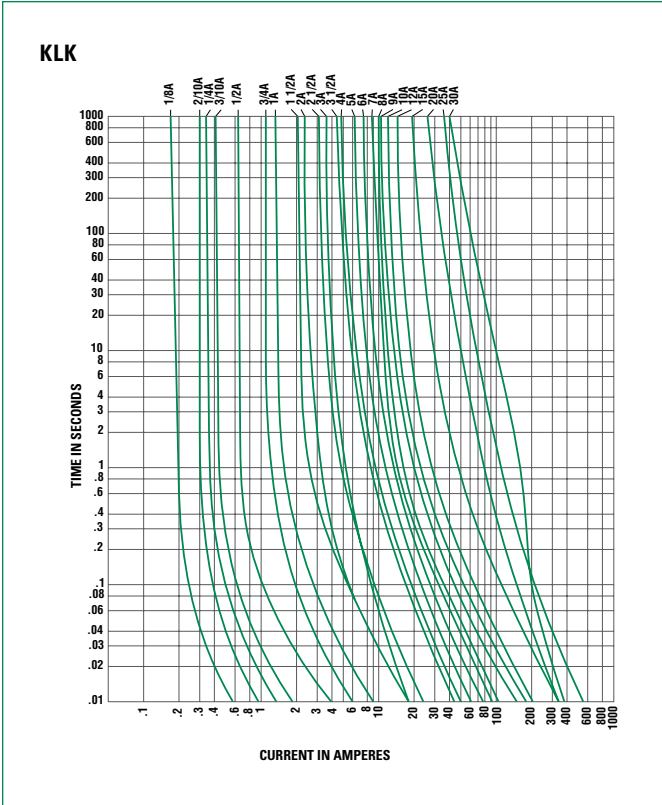

Electronic Fuses

3AG/3AB Type

312/318 Series 3AG Fast Acting Fuse



Designed for fast acting protection of electronic equipment and appliances. The "standard" fast acting, glass tube fuse.

Voltage Rating: 250V: $\frac{1}{100}$ – 10A.
32V: 12 – 35A.

Dimensions: $\frac{1}{4}$ " x $1\frac{1}{4}$ " (6.4 x 31.8mm)

Order 312 series without leads.

Example part number (series & amperage): **312.375**

Note: For fuses with axial leads, request 318 series.

To order a 3AG "Dummy" fuse request part number 310033.

Ampere Ratings:

$\frac{1}{100}$	$\frac{2}{10}$	1	$2\frac{1}{2}$	12
$\frac{1}{32}$	$\frac{1}{4}$	$1\frac{1}{4}$	3	15
$\frac{1}{16}$	$\frac{3}{10}$	$1\frac{1}{2}$	4	20
$\frac{1}{10}$	$\frac{3}{8}$	$1\frac{8}{10}$	5	25
$\frac{1}{8}$	$\frac{1}{2}$	$1\frac{3}{4}$	6	30
$\frac{15}{100}$	$\frac{6}{10}$	$1\frac{8}{10}$	7	35
0.175	$\frac{8}{10}$	2	8	
$\frac{3}{16}$	$\frac{3}{4}$	$2\frac{1}{4}$	10	

Approvals: Standard 248-14, UL Listed $\frac{1}{100}$ -10 Amps and UL Listed 12 – 30 Amps per Standard UL 275. CSA Certified through 30 Amps.

314/324 Series 3AB Fast Acting Fuse



Similar to 312 series, but ceramic tube permits additional ampere ratings: 250 volt ratings through 30 amps.

Voltage Rating: 250V: $\frac{1}{8}$ – 30A

Dimensions: $\frac{1}{4}$ " x $1\frac{1}{4}$ " (6.4 x 31.8mm)

Order 314 series without leads.

Example part number (series & amperage): **324.375**

Note: For fuses with axial leads, request 324 series.

Ampere Ratings:

$\frac{1}{8}$	$\frac{3}{4}$	4	8	20
$\frac{1}{4}$	1	5	10	25
$\frac{3}{8}$	2	6	12	30
$\frac{1}{2}$	3	7	15	

Approvals: Standard 248-14, UL Listed and CSA Certified $\frac{1}{8}$ – 15 Amps. UL Recognized under the Components Program and CSA Recognized under the Component Acceptance Program 20 – 30 Amps. Approved by MITI from 10 – 30 Amps.

313/315 Series 3AG SLO-BLO® Fuse



313 and 315 series fuses have time-delay in the overload range, which provides superior protection for inductive loads such as motors, transformers, and solenoids.

Voltage Rating: 250V: $\frac{1}{100}$ – 8A. 32V: 10 – 30A.

Dimensions: $\frac{1}{4}$ " x $1\frac{1}{4}$ " (6.4 x 31.8mm)

Order 313 series without leads.

Example part number (series & amperage): **313.500**

Note: For fuses with axial leads, request 315 series.

To order a 3AG "Dummy" fuse request part number 310033.

Ampere Ratings:

$\frac{1}{100}$	$\frac{15}{100}$	$\frac{3}{8}$	$\frac{8}{10}$	$1\frac{9}{10}$	$3\frac{7}{10}$	10
$\frac{1}{32}$	0.175	$\frac{4}{10}$	1	2	4	12
$\frac{4}{100}$	$\frac{3}{16}$	$\frac{1}{2}$	$1\frac{2}{10}$	$2\frac{1}{4}$	5	15
$\frac{1}{16}$	$\frac{3}{10}$	$\frac{9}{10}$	$1\frac{1}{4}$	$2\frac{1}{2}$	$6\frac{1}{4}$	20
$\frac{1}{10}$	$\frac{1}{4}$	$\frac{7}{10}$	$1\frac{1}{2}$	$2\frac{9}{10}$	7	25
$\frac{1}{8}$	$\frac{3}{10}$	$\frac{3}{4}$	$1\frac{6}{10}$	3	8	30

Approvals: Standard 248-14, UL Listed and CSA Certified $\frac{1}{100}$ -8 Amps. UL Recognized under the Components Program and CSA Recognized under the Component Acceptance Program 10 – 30 Amps. MITI approved 1 – 5 Amps.

326/325 Series 3AB SLO-BLO® Fuse



The 326 series fuse has time-delay similar to the 313 series, but the ceramic body permits higher voltage ratings for the 8 – 30 ampere sizes and faster opening of short-circuits.

Voltage Rating: 250V: $\frac{1}{100}$ – 20A.
125V: 25 – 30A.

Dimensions: $\frac{1}{4}$ " x $1\frac{1}{4}$ " (6.4 x 31.8mm)

Order 326 series without leads.

Example part number (series & amperage): **326012**

Note: For fuses with axial leads, request 325 series.

Ampere Ratings:

$\frac{1}{100}$	$\frac{3}{16}$	$\frac{9}{10}$	$1\frac{1}{2}$	4	15
$\frac{1}{32}$	$\frac{2}{10}$	$\frac{7}{10}$	$1\frac{6}{10}$	5	20
$\frac{1}{16}$	$\frac{1}{4}$	$\frac{3}{4}$	2	$6\frac{1}{4}$	25
$\frac{1}{10}$	$\frac{3}{10}$	$\frac{9}{10}$	$2\frac{1}{2}$	7	30
$\frac{1}{8}$	$\frac{3}{8}$	1	$2\frac{8}{10}$	8	
$\frac{15}{100}$	$\frac{4}{10}$	$1\frac{2}{10}$	3	10	
0.175	$\frac{1}{2}$	$1\frac{1}{4}$	$3\frac{3}{10}$	12	

Approvals: Standard 248-14, UL Listed $\frac{1}{4}$ – 10 Amps. UL Recognized under the Components Program 12-30 Amps. CSA Certified $\frac{1}{4}$ – 30 Amps.

Electronic Fuses

Indicating Types

229/230 Series 2AG SLO-BLO® Indicating Fuse



2AG indicating fuses instantly identify themselves upon opening by showing a discoloration of their glass bodies. Guesswork and time consuming circuit testing is eliminated. This unique design offers the same quality performance characteristics as the standard 2AG fuse design.

Voltage Rating: 250V: ¼ – 3½A; 125V: 4 – 7A

Dimensions: .177" x .57" (4.5 x 14.5mm)

For fuses with axial leads, request 230___S series.

Order 229___S series without leads.

Example part number (series & amperage): **22902.5S**

Ampere Ratings:

¼	¾	2	4
.350	8/10	2¼	5
⅜	1	2½	6
½	1¼	3	7
⅝	1½	3½	

Approvals: Standard 248-14, UL Listed and CSA Certified ¼ – 3½ Amps. UL Recognized under the Components Program and CSA Recognized under the Component Acceptance Program 4 – 7 Amps.

313 Series 3AG SLO-BLO® Indicating Fuse



3AG indicating fuses instantly identify themselves upon opening by showing a discoloration of their glass bodies. Guesswork and time consuming circuit testing is eliminated. This unique design offers the same quality performance characteristics as the standard 3AG fuse design.

Voltage Rating: 250V: ½ – 8A; 32V: 10A.

Dimensions: ¼" x 1¼": (6.4 x 31.8mm)

Example part number (series plus amperage, followed by "ID"): **313007ID**

Ampere Ratings:

½	1½	3	5	7	10
1	2	4	6¼	8	

Approvals: Standard 248-14, UL Listed and CSA Certified ½ – 8 Amps. The 10 Amp is UL Recognized under the Components Program and CSA Recognized under the Component Acceptance Program.

215 Series (Type T) 5 x 20mm SLO-BLO® Fuse



Time-delay protection of electronic equipment and appliances when fuses to International Standards are required. Replacement fuses for foreign equipment.

Voltage Rating: 250V AC

Design Standards: Meets IEC 60127-2, Sheet 5 Specification for Time Lag fuses.

Dimensions: 5mm x 20mm (.2 x .79 in.)

Example part number (series & amperage): **215.315**

Note: For fuses with axial leads add "XE" extension to the part number. Example 215.630XE

Ampere Ratings:

.200	.400	.800	1.6	3.15	6.3
.250	.500	1	2	4	8*
.315	.630	1.25	2.5	5	10*

*Available but not included in International Standards. Interrupting Capacity: 1500A

Approvals: UL Recognized under the Components Program and CSA Recognized under the Component Acceptance Program. SEMKO, VDE, and BSI approved 1 – 6.3 Amps. MITI approved 1 – 10 Amps.

Electronic Fuses

5 x 20mm IEC Type

216 Series (Type F) 5 x 20mm Fast-Acting Fuse



Fast acting protection of electronic equipment and appliances when fuses to International Standards are required. Replacement fuse for foreign equipment.

Voltage Rating: 250V AC
Design Standards: Meets IEC 60127-2, Sheet 1 Specification for Fast-Acting Fuses.
Dimensions: 5mm x 20mm (.2 x .79 in.)
 Example part number (series & amperage): **216.200**

Note: For fuses with axial leads add "XE" extension to the part number. Example 216.630XE

Ampere Ratings:

.050	.125	.315	.800	2	5
.063	.160	.400	1	2.5	6.3
.080	.200	.500	1.25	3.15	8*
.100	.250	.630	1.6	4	10*

*Available but not included in International Standards. Interrupting Capacity: 1500A

Approvals: UL Recognized under the Components Program and CSA Recognized under the Component Acceptance Program. SEMKO and VDE approved through 6.3 Amps. BSI approved 1 – 6.3 Amps.

217 Series (Type F) 5 x 20mm Fast-Acting Fuse



Fast-acting protection of electronic equipment and appliances when fuses to International Standards are required. Replacement fuse for foreign equipment.

Voltage Rating: 250V AC
Dimensions: 5mm x 20mm (.2 x .79 in.)
 Example part number (series & amperage): **217.050**
Design Standards: Meets IEC 60127-2, Sheet 2 Specification for Fast Acting Fuses.

Note: For fuses with axial leads add "XE" extension to the part number. Example 217.630XE

Ampere Ratings:

.032	.080	.200	.500	1.25	3.15	8*
.040	.100	.250	.630	1.6	4	10*
.050	.125	.315	.800	2	5	15*
.063	.160	.400	1	2.5	6.3	

*Available but not included in International Standards. Interrupting Capacity: 35A or 10x rated current, whichever is greater.

Approvals: UL Recognized under the Components Program and CSA Recognized under the Component Acceptance Program. SEMKO and VDE approved through 6.3 Amps. BSI approved 0.4 – 6.3 Amps.

218 Series (Type T) 5 x 20mm SLO-BLO® Fuse



Time-delay protection of electronic equipment and appliances when fuses to International Standards are required. Replacement fuses for foreign equipment.

Voltage Rating: 250V AC
Dimensions: 5mm x 20mm (.2 x .79 in.)
 Example part number (series & amperage): **218.630**
Design Standards: Meets IEC 60127-2, Sheet 3 Specification for Time Lag Fuses.

Note: For fuses with axial leads add "XE" extension to the part number. Example 218.630XE

Ampere Ratings:

.032	.080	.200	.500	1.25	3.15	8*
.040	.100	.250	.630	1.6	4	10*
.050	.125	.315	.800	2	5	15*
.063	.160	.400	1	2.5	6.3	

*Available but not included in International Standards. Interrupting Capacity: 35A or 10x rated current, whichever is greater.

Approvals: UL Recognized under the Components Program and CSA Recognized under the Component Acceptance Program. SEMKO and VDE approved through 6.3 Amps. BSI approved 0.8 – 6.3 Amps.

Electronic Fuses

5 x 20mm and 2AG Type

235 Series 5 x 20mm Fast-Acting fuse



5 x 20mm fuses designed to UL and CSA standards. Fast Acting protection of electronic equipment appliances.

Voltage Rating: 250V: 1/10 – 3A; 125V: 4 – 6A.

Dimensions: 5mm x 20mm (.2 x .79 in.)

Example part number (series & amperage): **235.600**

Note: For fuses with axial leads add "XE" extension to the part number. Example 235.600XE

Ampere Ratings:

1/10	3/10	7/10	1 6/10	4
1/8	4/10	8/10	2	5
2/10	1/2	1	2 1/2	6
1/4	6/10	1 1/4	3	

Approvals: Standard 248-14, UL Listed and CSA Certified. MITI approved 1 – 5 Amps.

239 Series 5 x 20mm SLO-BLO® fuse



5 x 20mm fuses designed to UL and CSA standards. For protection of electronic equipment and appliances.

Voltage Rating: 250V: 2/10 – 3A. 125V: 4A.

Dimensions: 5mm x 20mm (.2 x .79 in.)

Example part number (series & amperage): **239.400**

Note: For fuses with axial leads add "XE" extension to the part number. Example 239.600XE

Ampere Ratings:

2/10	4/10	7/10	1	2	4
1/4	1/2	3/4	1 1/4	2 1/2	5
3/10	6/10	8/10	1 6/10	3	

Approvals: Standard 248–14, UL Listed and CSA Certified. MITI approved 1 – 5 Amps.

225/224 Series 2AG Fast-Acting fuse



Fast acting performance of the 312, 3AG fuses in less than one-third the space. For protection of electronic equipment and appliances.

Voltage Rating: 250V: 1/4 – 3 1/2A. 125V: 4 – 10A

Dimensions: 2AG Fuse .177" x .57" (4.5 x 14.5mm)

Example part number (series & amperage): **224.500**

Note: For fuses with axial leads, request series number 224. Order 225 series without leads.

Ampere Ratings:

1/10	3/8	1	2 1/2	4	7
1/8	1/2	1 1/2	3	5	8
1/4	3/4	2	3 1/2	6	10

Approvals: Standard 248–14, UL Listed and CSA Certified. 224 series approved by MITI 1 – 5 Amps.

229/230 Series 2AG SLO-BLO® fuse



229 series 2AG fuses have time-delay of 313 series 3AG fuses in less than one-third the space. They provide superior protection for inductive loads such as motors, transformers, and solenoids. Use whenever time-delay fuses are indicated.

Voltage Rating: 250V: 1/4 – 3 1/2A; 125V: 4 – 7A.

Dimensions: 2AG Fuse .177" x .57" (4.5 x 14.5mm)

Example part number (series & amperage): **229.375**

Note: For fuses with axial leads, request series number 230. Order 229 series without leads.

Ampere Ratings:

1/4	5/10	1 1/2	2 1/2	4	6
3/8	3/4	2	3	5	7
1/2	1	2 1/4	3 1/2		

Approvals: Standard 248-14, UL Listed and CSA Certified 1/4 – 3 1/2 Amps. UL Recognized under the Components Program and CSA Recognized under the Component Acceptance Program 4 – 7 Amps.

Electronic Fuses

Subminiature Type

272/278 Series Fast-Acting Microfuse



Fast acting Microfuses for protection of printed circuit boards and similar equipment.

Voltage Rating: 125V AC
 Example part number (series & amperage): **27201.5**
Note: 278 series has 1" leads

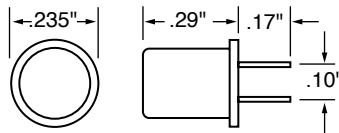

Ampere Ratings:

1/500	1/32	1/8	1/4	3/4	2
1/200	1/20	3/10	1/2	8/10	3
1/100	1/16	1/4	6/10	1	4
1/64	1/10	3/10	7/10	1 1/2	5

Approvals: UL Recognized under the Components Program and CSA Recognized under the Component Acceptance Program.
 For data on 262 and 268 series High Reliability (Hi-Rel) microfuses, request Electronic Catalog.

273/279 Series Fast-Acting Microfuse



Similar to 272 and 278 series, except has transparent cap for visual indication of fuse status.

Voltage Rating: 125V AC
 Example part number (series & amperage): **273002**
Note: 279 series has 1" leads

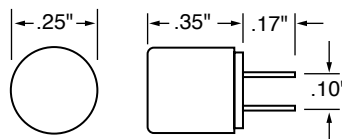

Ampere Ratings:

1/500	1/32	1/8	1/4	3/4	2
1/200	1/20	3/10	1/2	8/10	3
1/100	1/16	1/4	6/10	1	4
1/64	1/10	3/10	7/10	1 1/2	5

Approvals: UL Recognized under the Components Program and CSA Recognized under the Component Acceptance Program.

251/252 Series Fast-Acting Pico®II Fuse

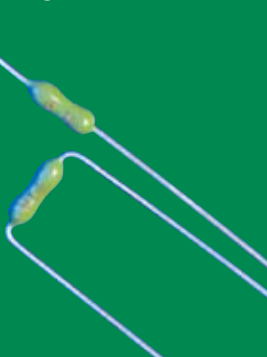

Subminiature fuse for soldered mounting on printed circuit boards. Available on tape and reel for automatic insertion.

Voltage Rating: 125V: 1/16 – 10A; 32V: 12 – 15A.
 Example part number (series & amperage): **251.125**

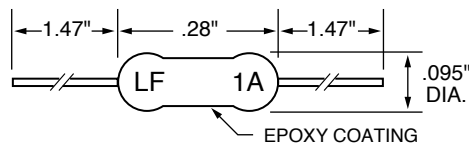

Ampere Ratings:

1/16	3/8	1	2 1/2	4	10
1/8	1/2	1 1/2	3	5	12
1/4	3/4	2	3 1/2	7	15

Approvals: UL Recognized under the Components Program and CSA Recognized under the Component Acceptance Program.
 Order 252 series for radial leads. To order PICO II fuses with ampere ratings color-coded, order 255 series for axial leads and 256 for radial leads.
 For data on 265 and 266 series High Reliability (Hi-Rel) Pico fuses, request Electronic Catalog. For information on PICO II 250V fast-acting fuses, contact factory.

473 Series SLO-BLO® Pico®II Fuse



Subminiature time-delay fuse for soldered mounting on printed circuit boards. Available on tape and reel for automatic insertion. Request bulletin PB-1027 for further information.

Voltage Rating: 125V AC
 Example part number (series & amperage): **473005**

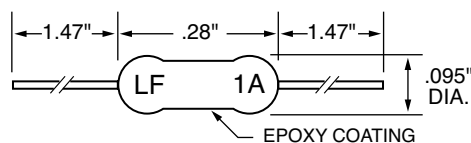

Ampere Ratings:

3/6	3/4	1 1/2	2 1/4	3	4	7
1/2	1	2	2 1/2	3 1/2	5	

Approvals: UL Recognized under the Components Program and CSA Recognized under the Component Acceptance Program. MITI approved 1 – 5 Amp.

Automotive Fuses

SFE and Blade Type

SFE Series Fast-Acting Fuse



Low voltage fuse for automotive and electronic applications.

Voltage Rating: 32V AC/DC

Approvals: UL Listed under UL Standard #275.

Society of Automotive Engineers (SAE) J554.

Example part number (series & amperage): **SFE006**

Ampere Ratings/Dimensions:

Ampere Rating	Length	Diameter
4	5/8"	1/4"
6	3/4"	1/4"
7 1/2	7/8"	1/4"
9	7/8"	1/4"
14	1 1/16"	1/4"
20	1 1/4"	1/4"
30	1 1/16"	1/4"

ATO® /257 Series Fast-Acting Fuse

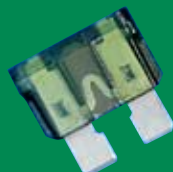

The 257 series ATO fuse is a low voltage blade type fuse for automotive and electronic applications. Designed, originated and patented by Littelfuse, it has become the standard for OEM circuit protection on foreign and domestic autos and trucks. They are color-coded and readily identifiable and may be specified for a variety of low voltage applications.

Voltage Rating: 32V AC/DC

Example part number (series & amperage): **ATO015**

Approvals: UL Listed. CSA Certified 3 – 30 A.

Catalog No.	Amp. Rating	Volt. Rating	Color Code
ATO 001	1	32	Black
ATO 002	2	32	Grey
ATO 003	3	32	Violet
ATO 004	4	32	Pink
ATO 005	5	32	Tan
ATO 07.5	7 1/2	32	Brown
ATO 010	10	32	Red
ATO 015	15	32	Blue
ATO 020	20	32	Yellow
ATO 025	25	32	Natural
ATO 030	30	32	Green
ATO 040	40	32	Orange

RoHS

MIN/297 Series MINI® Fast-Acting Fuse



The MINI fuse is smaller than its predecessor, the ATO fuse, which permits using more fuses in the same amount of space. More fuses in the same space satisfies the requirement that more circuits be individually fused in newer automobiles. Patented by Littelfuse.

Voltage Rating: 32V AC/DC

Example part number (series & amperage): **MIN025**

Approvals: UL Listed.

Note: For low-profile MINI® fuse, request 897 series

Catalog No.	Amp. Rating	Volt. Rating	Color Code
MIN 002	2	32	Grey
MIN 003	3	32	Violet
MIN 004	4	32	Pink
MIN 005	5	32	Tan
MIN 07.5	7 1/2	32	Brown
MIN 010	10	32	Red
MIN 015	15	32	Blue
MIN 020	20	32	Yellow
MIN 025	25	32	Natural
MIN 030	30	32	Green

RoHS

MAX/299 Series MAXI™ SLO-BLO® Fuse

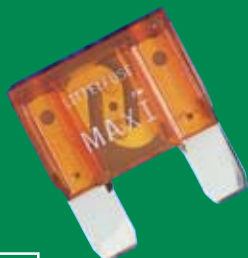

The patented MAXI Fuse is available in a higher range of amperage ratings (20 – 80 amperes) than the ATO or MINI fuses, and is physically larger in size. It is color-coded for easy identification. A typical MAXI Fuse application, in today's more sophisticated automobile circuits, is protection of the wiring harness by replacing the fusible wire or fusible link which is often a plain piece of small wire.

Voltage Rating: 32V AC/DC

Example part number (series & amperage): **MAX070**

Approvals: UL Listed.

Catalog No.	Amp. Rating	Volt. Rating	Color Code
MAX 020	20	32	Yellow
MAX 030	30	32	Green
MAX 040	40	32	Orange
MAX 050	50	32	Red
MAX 060	60	32	Blue
MAX 070	70	32	Tan
MAX 080	80	32	Natural

RoHS

Automotive Fuses

Bolt-On Type



MEGA® SLO-BLO® Bolt-On Fuse

The MEGA Fuse is designed for the protection of high current applications. Designed and patented by Littelfuse, it is ideal for battery and alternator protection and other heavy gauge cable applications.

Specifications

RoHS

Voltage Rating: 32V AC/DC
Interrupting Rating: 2000 A @ 32VDC

Catalog No.	Amp. Rating	Volt. Rating	Color Code
MEG100	100	32	Yellow
MEG125	125	32	Green
MEG150	150	32	Orange
MEG175	175	32	White
MEG200	200	32	Blue
MEG225	225	32	Tan
MEG250	250	32	Pink

Example part number (series & amperage): **MEG200**

Recommended Fuse Holder

298900



MIDI® SLO-BLO® Bolt-On Fuse

The patented design of the Littelfuse MIDI fuse offers a bolt-on space saving fuse with SLO-BLO characteristics for high current wiring protection.

Specifications

RoHS

Voltage Rating: 32V AC/DC
Interrupting Rating: 1000 A @ 32VDC

Catalog No.	Amp. Rating	Volt. Rating	Color Code
498030	30	32	Pink
498040	40	32	Green
498050	50	32	Red
498060	60	32	Yellow
498070	70	32	Brown
498080	80	32	White
498100	100	32	Blue
498125	125	32	Orange
498150	150	32	Grey
498200	200	32	Violet

Example part number (series & amperage): **498080**

Recommended Fuse Holder

498900

Automotive Fuses

Miscellaneous



JCASE® SLO-BLO® Fuse

RoHS

The patented JCASE is a cartridge style fuse with female terminals. It was designed to provide increased time-delay to handle in-rush currents and low voltage drop to protect high current automotive circuits.

Specifications

Voltage Rating: 32V AC/DC
Interrupting Rating: 1000 A @ 32VDC

Catalog No.	Amp. Rating	Volt. Rating	Color Code
JCAS20	20	32	Blue
JCAS30	30	32	Pink
JCAS40	40	32	Green
JCAS50	50	32	Red
JCAS60	60	32	Yellow

Example part number (series & amperage): **JCAS60**



Specifications

RoHS

Voltage Rating: 32V AC/DC
Interrupting Rating: 2000 A @ 32VDC

Catalog No.	Amp. Rating	Volt. Rating	Wire Gauge
496060	60	32	10AWG
496080	80	32	8AWG
496100	100	32	8AWG
496125	125	32	6AWG
496150	150	32	4AWG
496175	175	32	4AWG
496200	200	32	4AWG

Example part number (series & amperage): **496060**

Standard item: 1 foot cable on one side; 3 foot cable on the other side.

CablePro® Cable Protector Fuse

The CablePro Fuse is a high performance alternative for providing a reliable, safe, and cost effective fusible link. It provides similar circuit protection as the MEGA® fuse in a slim package that fits into tight locations. The standard CablePro features 1 one foot wire lead and 1 three foot wire lead. Contact the factory for custom wire lead lengths.